

KASPAPURAM VILLAGE

VILLAGE BOUNDARY

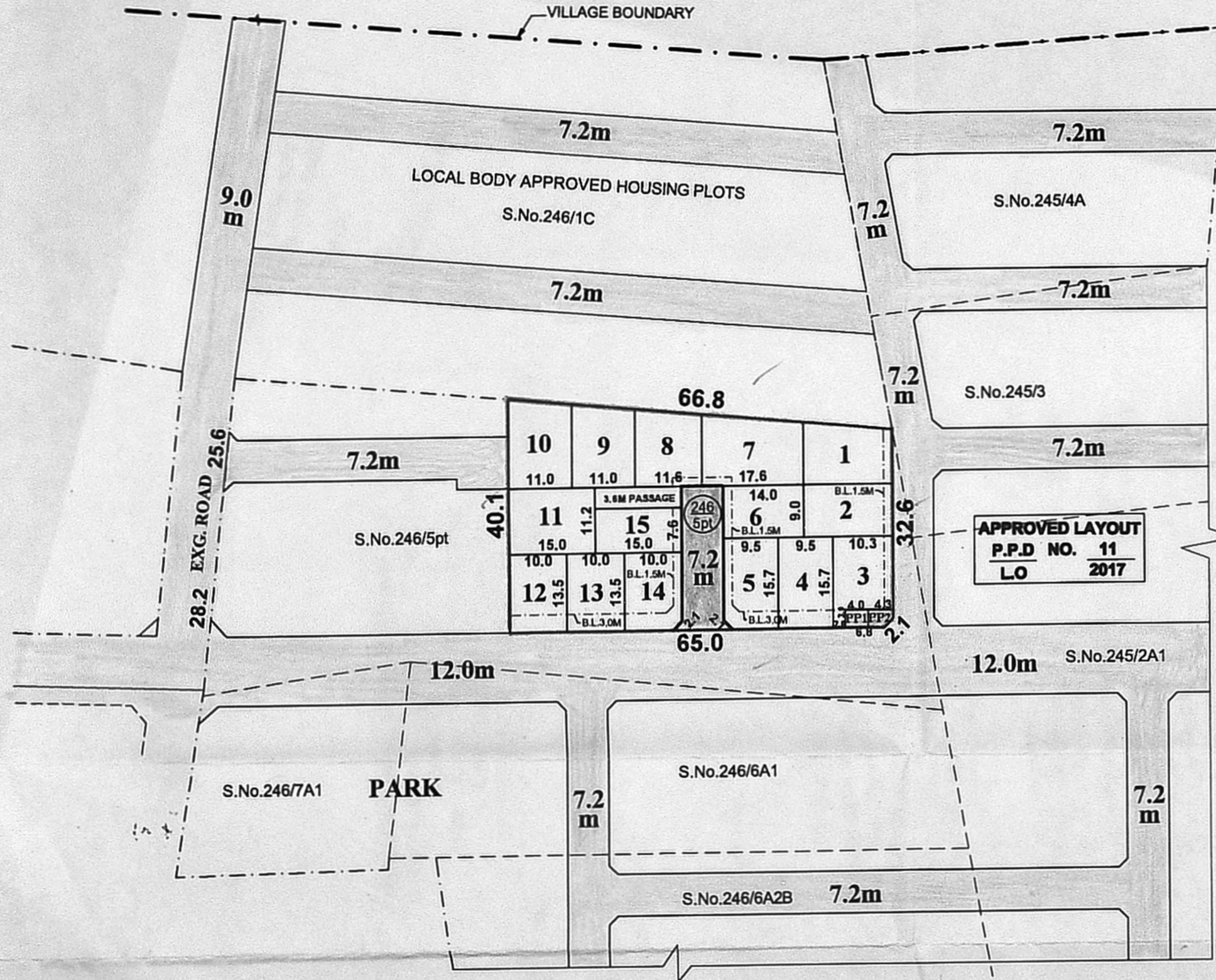

TOTAL EXTENT (AS PER APPD. LAYOUT) = 2465 Sq.M
ROAD AREA = 180 Sq.M
PUBLIC PURPOSE AREA (1%) = 24 Sq.M
 PP-1 HANDED OVER TO THE LOCAL BODY (0.5%) = 12.0 Sq.m
 PP-2 HANDED OVER TO THE TANGEDCO (0.5%) = 12.0 Sq.m
TOTAL NO. OF PLOTS = 15 Nos.

NOTE:

1. SPLAY - 1.5M x 1.5M
2. MEASUREMENTS ARE INDICATED EXCLUDING SPLAY DIMENSIONS
3. ROAD AREA WAS HANDED OVER TO THE LOCAL BODY VIDE GIFT DEED DOC.NO: 5767/2019, DATED:19.07.2019 @ SRO, TAMBARAM
4. PUBLIC PURPOSE-1 (0.5%) WAS HANDED OVER TO THE TANGEDCO VIDE GIFT DEED DOC.NO: 5833/2019, DATED:23.07.2019 @ SRO, TAMBARAM

CONDITIONS:

(I) TNCDBR RULE NO: 47 (11)

THE COST OF LAYING IMPROVEMENTS TO THE SYSTEMS IN RESPECT OF ROAD, WATER SUPPLY, SEWERAGE, DRAINAGE OR ELECTRIC POWER SUPPLY THAT MAY BE REQUIRED AS ASSESSED BY THE CONCERNED AUTHORITY, NAMELY, THE LOCAL BODY AND TAMIL NADU ELECTRICITY BOARD, SHALL BE BORNE BY THE APPLICANT.

(II) TNCDBR-2019 RULE NO: 47 (8)

ONE PERCENT OF LAYOUT AREA EXCLUDING ROAD, ADDITIONALLY, SHALL BE RESERVED FOR "PUBLIC PURPOSE". WITHIN THE ABOVE CEILING 0.5% OF AREA SHALL BE TRANSFERRED TO THE LOCAL BODY AND 0.5% OF AREA SHALL BE TRANSFERRED TO THE TANGEDCO FREE OF COST THROUGH A REGISTERED GIFT DEED BEFORE THE ACTUAL SANCTION OF THE LAYOUT.

LEGEND

- SITE BOUNDARY
- ROADS GIFTED TO THE LOCAL BODY
- EXISTING ROAD
- PUBLIC PURPOSE-1 GIFTED TO THE LOCAL BODY
- PUBLIC PURPOSE-2 GIFTED TO THE TANGEDCO

CONDITIONS:

THE LAYOUT APPROVED IS VALID SUBJECT TO OBTAINING SANCTION FROM THE LOCAL BODY CONCERNED.

P.P.D NO : 83
 L.O 2019

APPROVED

VIDE LETTER NO : L1/5462/2019
 DATE : /08/2019

FOR SENIOR PLANNER (MSB/LAYOUT)
 CHENNAI METROPOLITAN
 DEVELOPMENT AUTHORITY

PREPARED BY P.A-IV (S.M)

CHECKED BY P.A.II(S.R) N BY

A.P.(S.A)

ST.THOMAS MOUNT PANCHAYAT UNION

SKETCH SHOWING THE LAYOUT OF PUBLIC PURPOSE PLOT Nos: I&II LYING IN THE APPROVED LAYOUT

P.P.D/L.O.No:11/2017 INTO RESIDENTIAL PLOTS IN S.Nos: 246/5pt OF AGARAMTHEN VILLAGE.

SCALE : 1:800 (ALL MEASUREMENTS ARE IN METRE.)

